



Fitting Rooms

Data Sheet

General Description: Stylmark offers components and hardware that can be used to create a variety of custom fitting room configurations. Fitting Room extrusions are sold in stock length or material may be fabricated to meet your specific design requirements.

Applications: Retail fitting rooms, restrooms, partitions

Material: Anodized aluminum
Anodized Finish: See Stylmark Color Library
Panels & Doors: Customer supplied or ask us to work with you to create a custom design

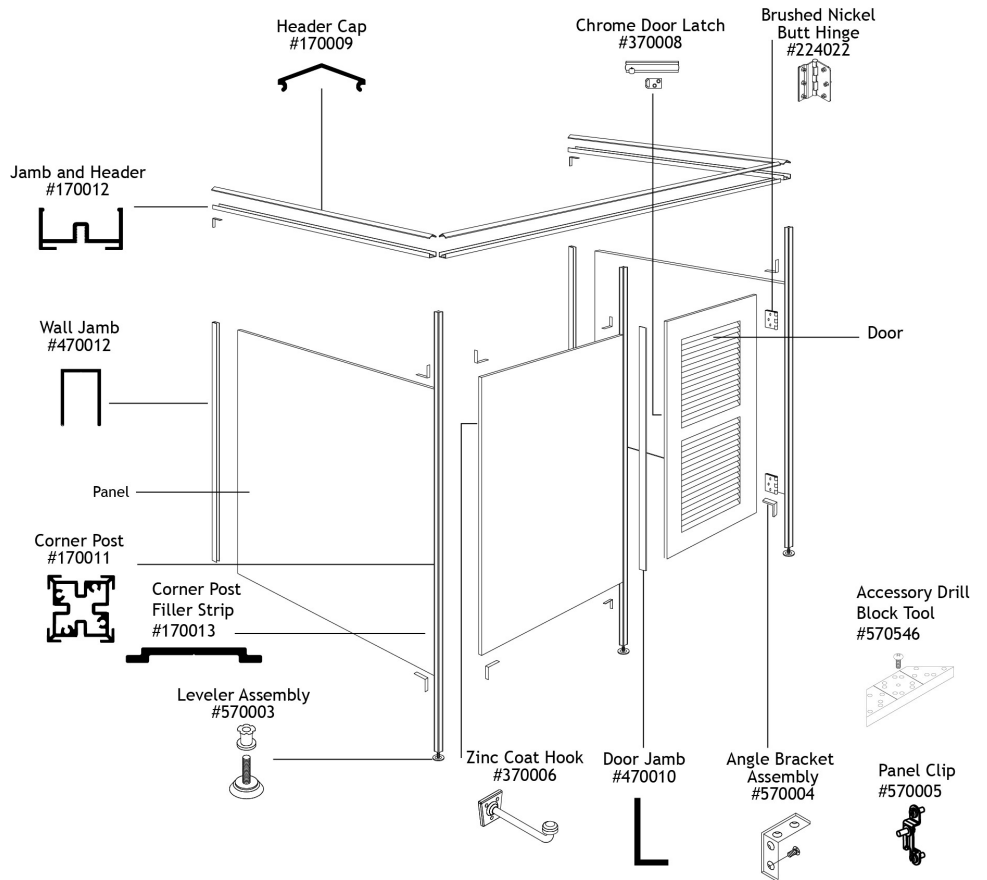

In order to continually improve our products, Stylmark reserves the right to make changes to specifications or materials without prior notice.

Sheet# 971621
 Revision E (6/25)