

Glass Clips

Stylmark's Glass Clips provide added strength to interior glass walls by holding panels of glass in line with one another. These durable anodized aluminum clips provide decorative accents and accommodate 3/8" or 1/2" thick glass panels. The clips install easily with screws and plastic insulators protect the glass from fractures or chips. Pair Stylmark Glass Clips with our WallMaker system to ensure your interior glass wall meets city building codes and maintains a cohesive, high-quality look.

ORDERING GLASS CLIPS		
ASSEMBLY #	DESCRIPTION	GLASS THICKNESS
232045	RECTANGULAR - 135 DEGREE CLIP	3/8" OR 1/2"
511008	RECTANGULAR - 90 DEGREE CLIP	3/8" OR 1/2"
510571	SQUARE - 180 DEGREE CLIP	3/8" OR 1/2"
510572	ROUND - 180 DEGREE CLIP	3/8" OR 1/2"
510582	ROUND - 90 DEGREE WALL MOUNT	3/8" OR 1/2"
510583	SQUARE - 90 DEGREE WALL MOUNT	3/8" OR 1/2"
510584	ROUND - 90 DEGREE CLIP	3/8" OR 1/2"
510585	SQUARE - 90 DEGREE CLIP	3/8" OR 1/2"
510586	ROUND - 135 DEGREE CLIP	3/8" OR 1/2"
510587	SQUARE - 135 DEGREE CLIP	3/8" OR 1/2"
510955	RECTANGULAR - 180 DEGREE CLIP	3/8" OR 1/2"

Round Glass Clips

Part #510572
Round - 180° Clip

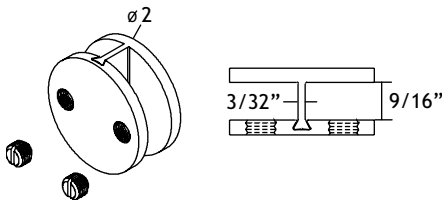

Part #510582
Round - 90° Wall Mount

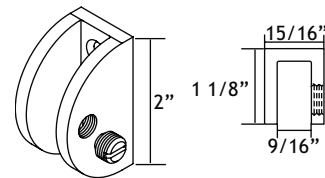

Part #510584
Round - 90° Clip

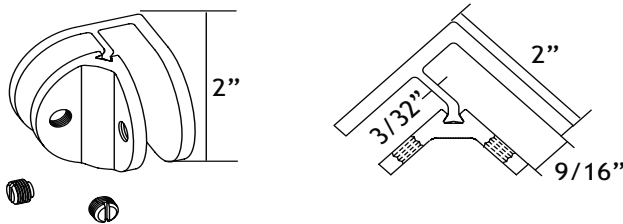

Part #510586
Round - 135° Clip

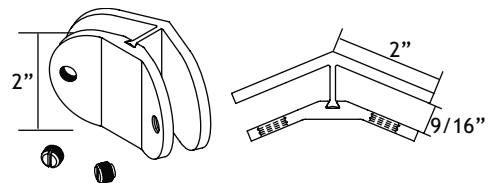

Glass Clips

Square Glass Clips

Part #510571
Square - 180° Clip

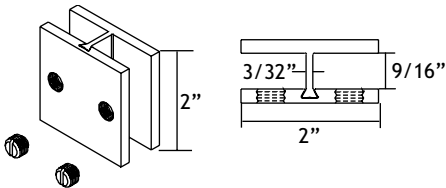

Part #510585
Square - 90° Clip

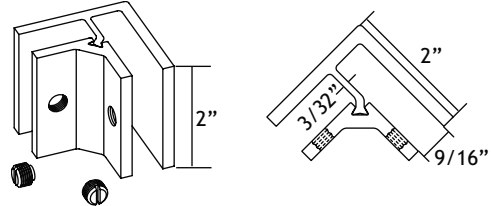

Part #510583
Square - 90° Wall Mount

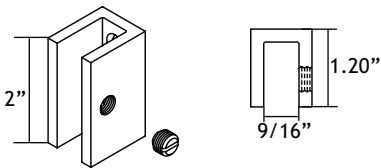

Part #510587
Square - 135° Clip

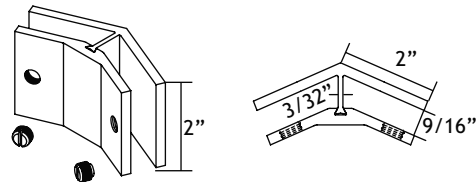

Rectangular Glass Clips

Part #232045
Rectangular - 135° Clip

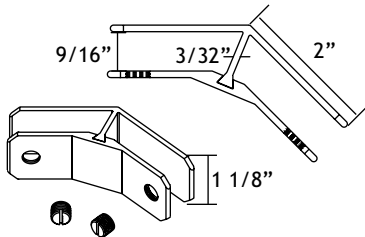

Part #510955
Rectangular - 180° Clip

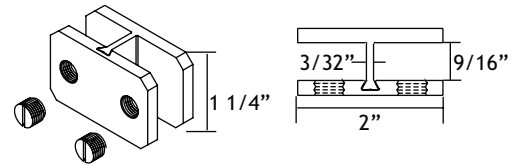

Part #511008
Rectangular - 90° Clip

