

Rectangulars

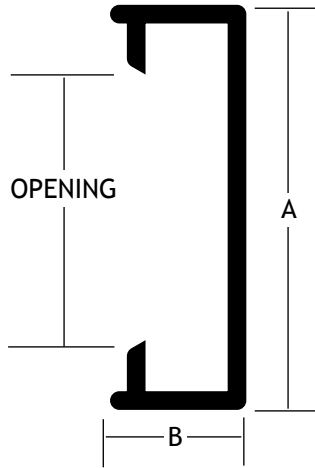

PART #	A	B	OPENING	BASE NUMBER(S)	ENDCAP NUMBER
110223	1 3/8"	2 1/64"	1"	410443, 410466	310212
110225	1 1/2"	1/2"	1"	410443, 410466	310213
110226	3"	3/4"	2"	410540	310214
110227	4"	3/4"	3"	410458*	310215
110232	4"	2"	3"	410458	310218
110245	3"	1 1/2"	2"	410540	310229
110248	1"	1/2"	5/8"	411331	-
110260	5"	3/4"	4 1/2"	412002	-
110269	6"	3/4"	4 1/2"	412002	310235
110294	1 1/2"	1/2"	1"	410443, 410466	310241
110304	2 1/4"	1/2"	1"	410443, 410466	310251
110307	2"	5/8"	1"	410443, 410466	310250
110410	3/4"	3/4"	5/8"	411331	310403
110639	2"	1"	1"	410443, 410466	-
110672	3/4"	3/16"	21/32"	412007	-

Part # 110223

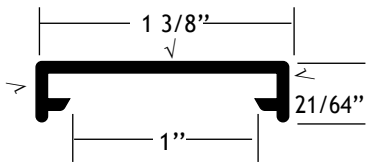

Base: 410443, 410466
Endcap: 310212

Part # 110225

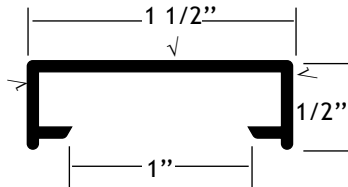

Base: 410443, 410466
Endcap: 310213

Part # 110226

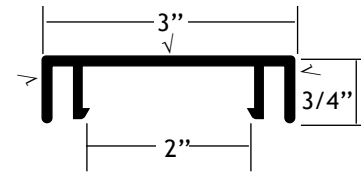

Base: 410540
Endcap: 310214

Part # 110227

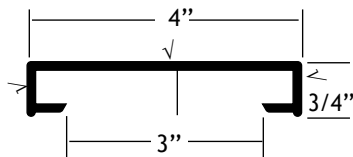

Base: 410458
Endcap: 310215

Part # 110232

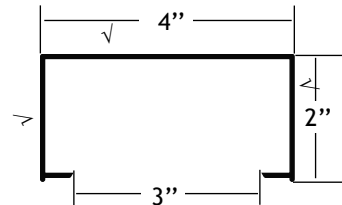

Base: 410458
Endcap: 310218

√ = finished surface
Drawings are not to scale

Rectangulars

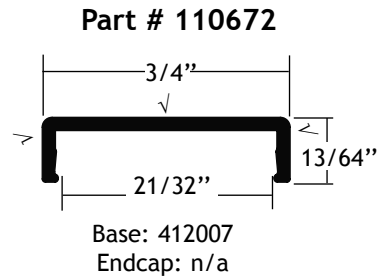
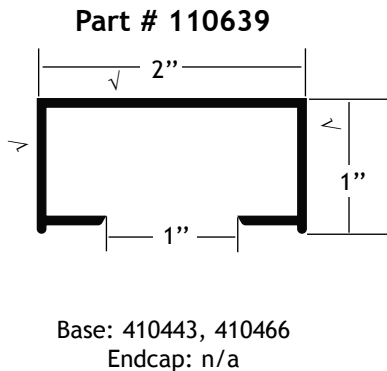
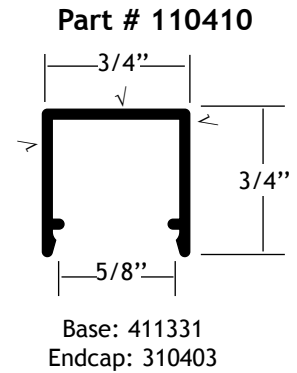
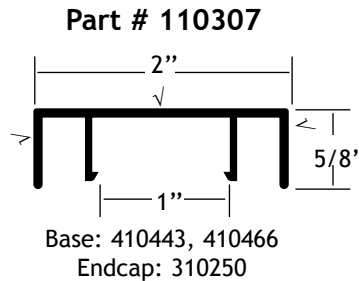
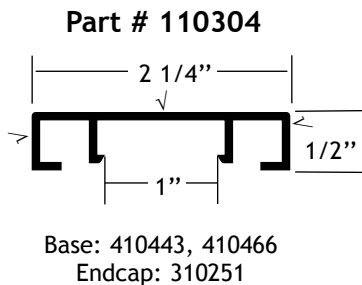
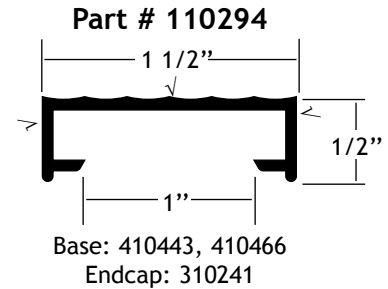
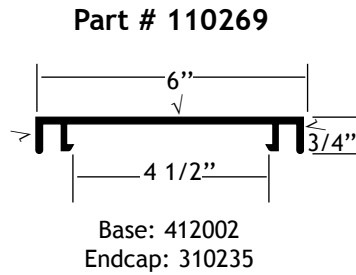
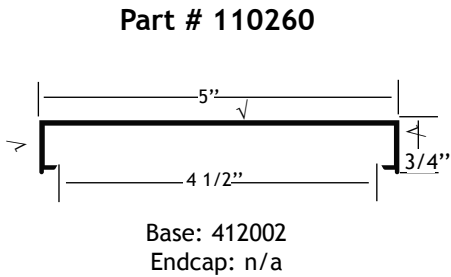
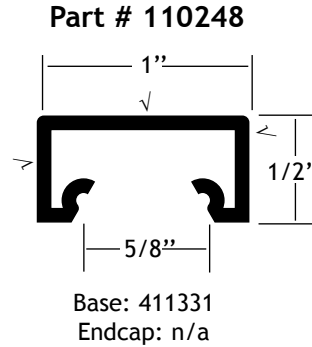
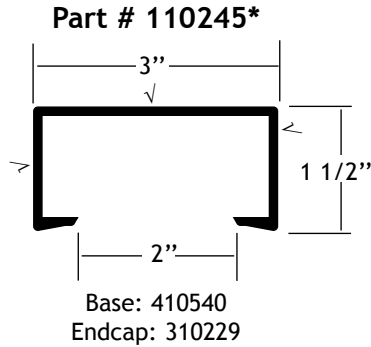

√ = finished surface
Drawings are not to scale

- Notes:
- Stylmark's anodized finishes are not recommended for outdoor applications.
 - Part #110245 is special order only