



Data Sheet



Quick-Change Graphic System

General Description: Designed from Stylmark's Trim Maker® line of aluminum extrusions & Porsa™ Extrusion System, the Quick-Change Graphic System allows easy changeability of your graphic without having to change an entire display. Stylmark is an authorized North American distributor of the Porsa™ system of Denmark. Porsa is the only aluminum extrusion system that accepts a 1/2" thick in-fill panel, making it ideal for applications require strength, stability and dependability

Functionality: The Trim Maker extrusion with base is mounted to a Porsa extrusion where inside the channel spring clip graphic holders are placed on the graphic then slid into the channel of the Porsa extrusion. To change the graphic, remove the Porsa end cap, slide off out the graphic and slide in the new graphic.

Applications: Graphic displays, signs, specialty fixtures

- Material:** Anodized aluminum
- Anodized Finish:** See Stylmark Color Library
- Trim Maker Profiles:** Quarter Rounds, Half Rounds, Rectangular, Special Shapes & Custom Profiles
- Trim Maker Endcaps:** Friction fit tabs into the base or mechanically fasten tab to the base

Spring Clip Graphic Holder

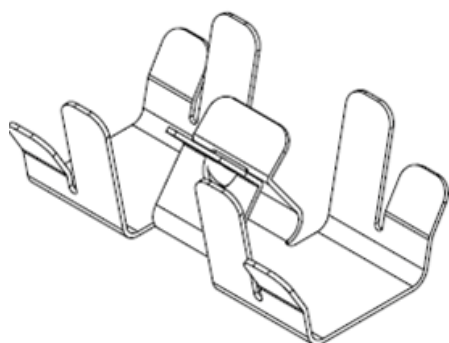

Recommended graphic thickness:
3MM (.118") Spring Clip Graphic Holder will hold panel thickness ranging from 2MM (.078") thru 4MM (.157").

In order to continually improve our products, Stylmark reserves the right to make changes to specifications or materials without prior notice.

Quick-Change Graphic System

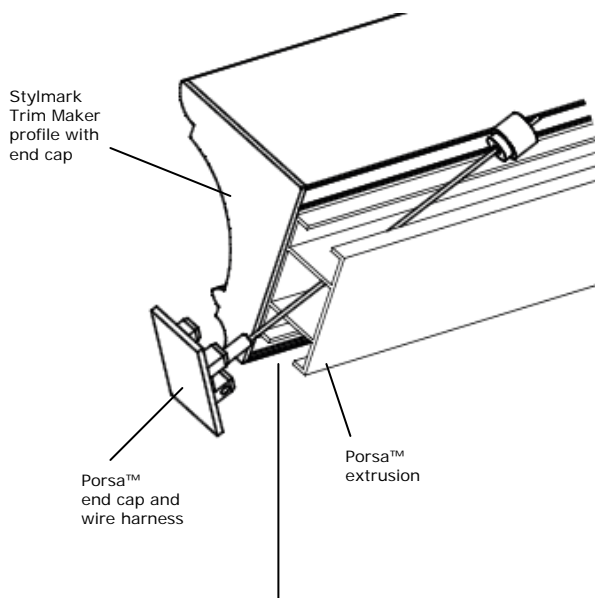

Insert spring clip graphic holder into Porsa™ channel and secure end cap into place